

Technische specificaties

trailer house / tiny house on wheels

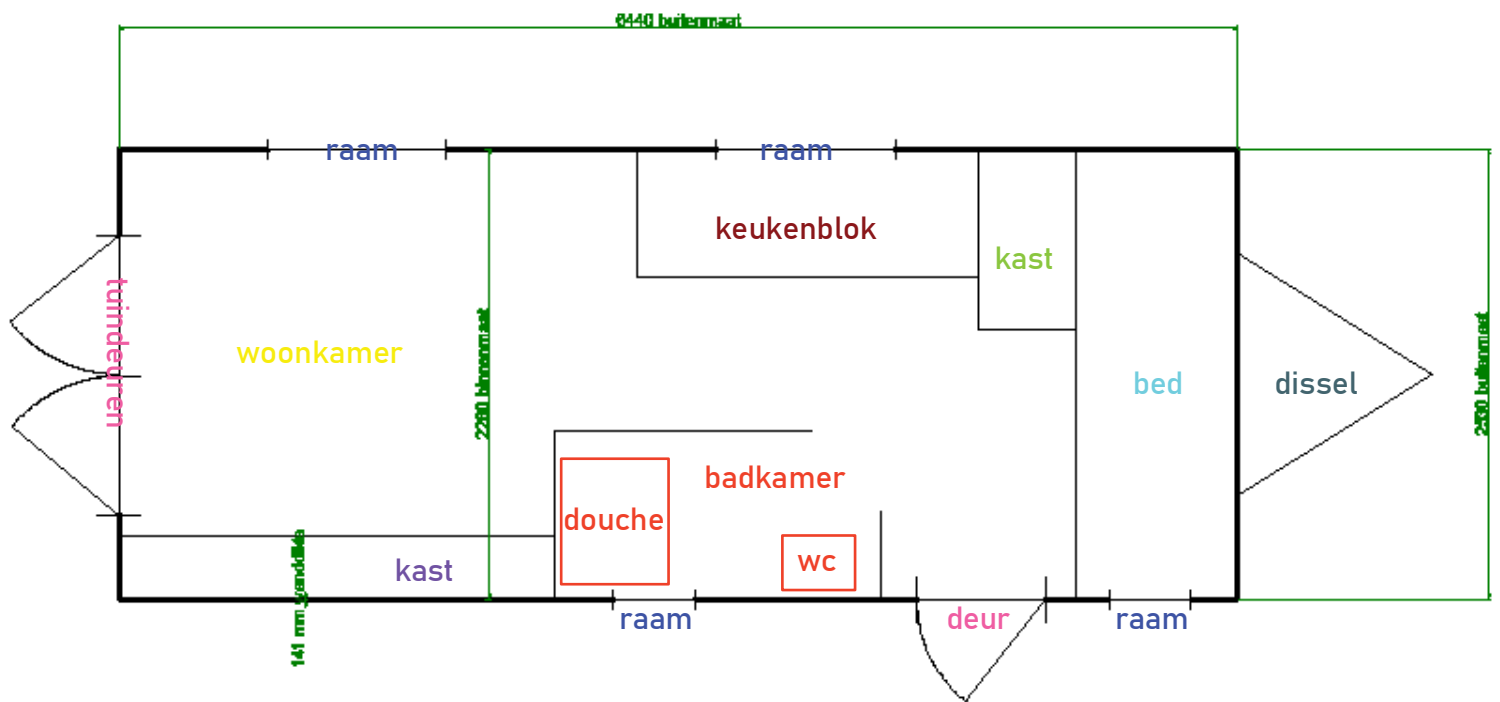



vloerplan
maten in mm

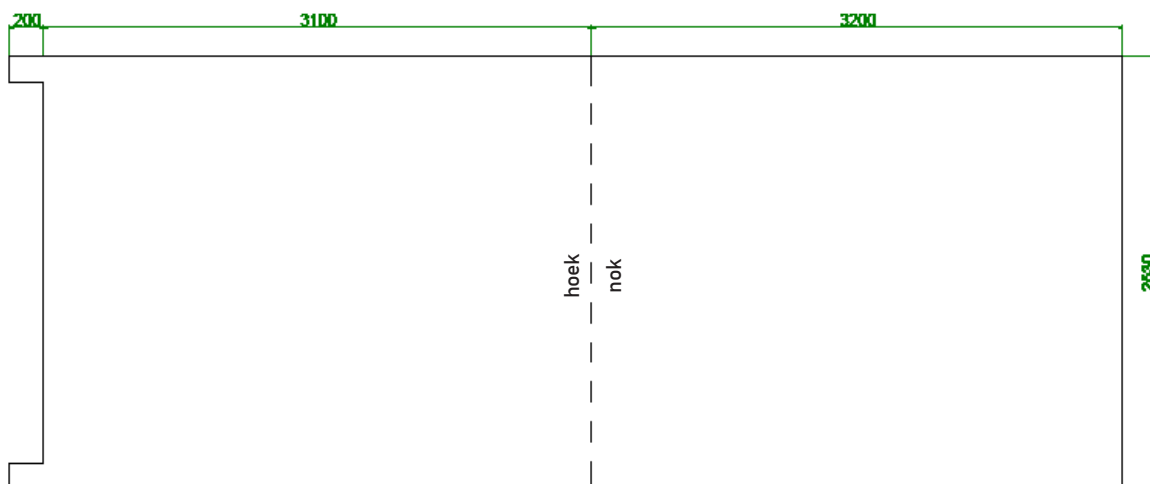

bovenaanzicht - dak
buitenmaten in mm

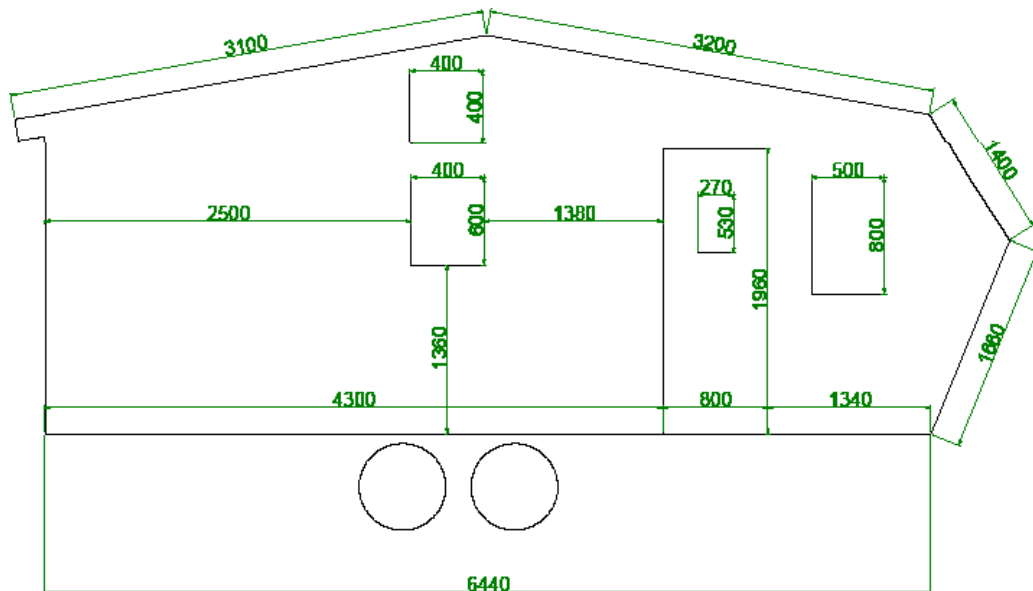

zijaanzicht -
noord buitenmaten
in mm

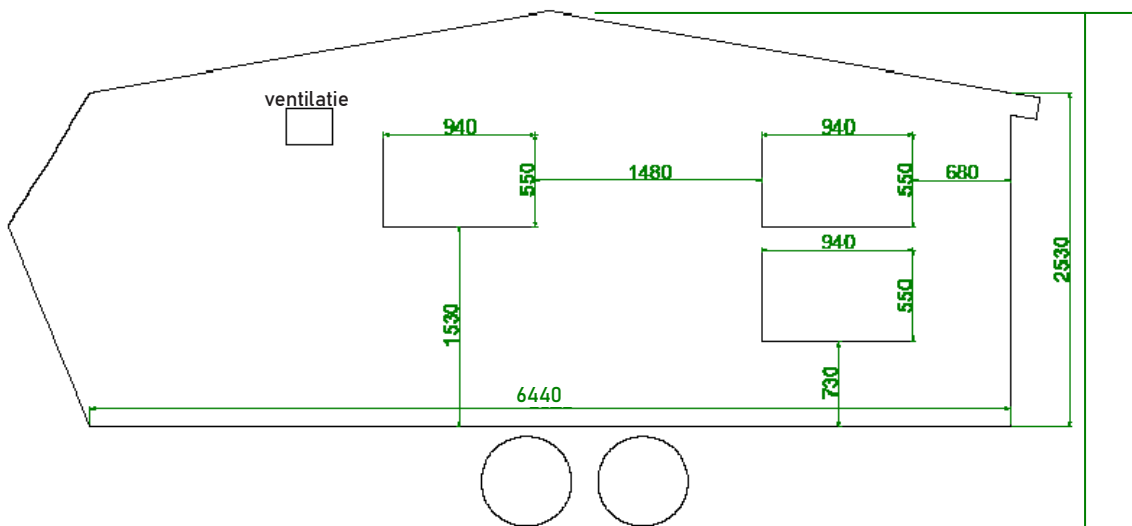

3550
hoogte op standplaats tot de

zijaanzicht -
zuid buitenmaten
in mm

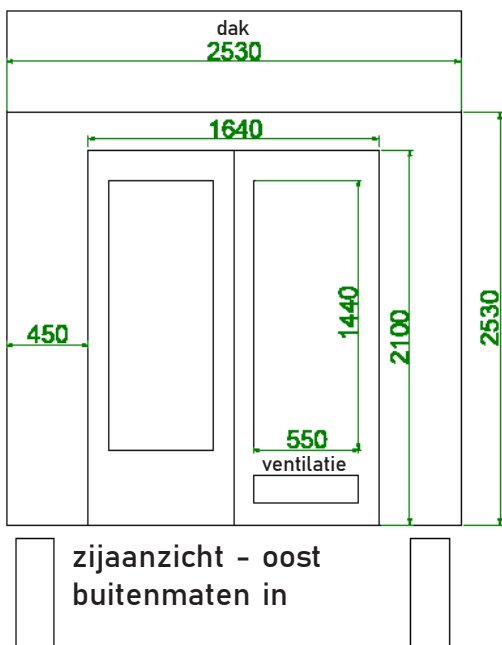

zijaanzicht - oost
buitenmaten in

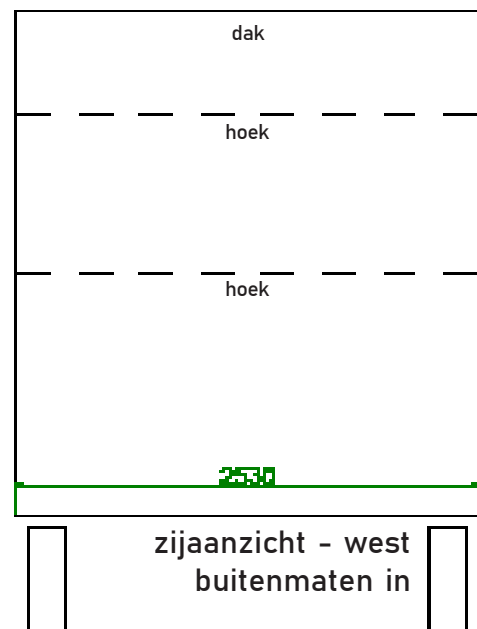

zijaanzicht - west
buitenmaten in

EC CERTIFICATE OF CONFORMITY

for complete vehicles

The undersigned W. Vlemmix (Director) hereby certifies that the vehicle:

0.1.	Make (Trade name of manufacturer)	VLEMMIX
0.2.	Type	VTA
	Variant	35
	Version	VOB
	Commercial name	VOB
0.2.1.	Commercial name	VOB
0.4.	Vehicle category	O2
0.5.	Name and address of manufacturer	Vlemmix Aanhangers Voorste Heusden 5 5725 AA Asten Nederland
	Location and method of attachment of the statutory plates	At the right hand side front of the trailer by means of blind rivets or self adhesion.
	Location of the vehicle identification number	At the right hand side front of the trailer
	0.9.	Name and address of the manufacturer's representative (if any)
0.10.	Vehicle identification number	XRUVTA00018000906

conforms in all respects to the type described in

approval	e4*2007/46*0170*05
issued on	11 April 2018

and can be permanently registered in Member States having right hand traffic and using metric or imperial units for the speedometer

Place:	Asten
Date:	19 June 2018

Signature:



W. Vlemmix

Voorste Heusden 5
5725 AA Asten
Nederland

Tel. Rick 06 - 53 14 07 16
Tel. Wim 06 - 50 29 86 72
Fax 0493 - 69 84 73

BTW nr. NL 8155.84.519.B.01
KvK nr. 17177364
BIC RABONL2U

IBAN nr. NL91 RABO 0163 6588 54
E-mail wm.vlemmix@planet.nl
www.vlemmixaanhangwagens.nl

General construction characteristics					
1.	Number of axles		2		
	Number of wheels		4		
1.1.	Number and position of axles with twin wheels		N/A		
Main dimensions					
4.	Wheelbase		5070	mm	
4.1.	Axle spacing	1 - 2 :	800	mm	
		2 - 3 :	N/A	mm	
5.	Length		7700	mm	
6.	Width		2550	mm	
7.	Height		1000	mm	
10.	Distance between the centre of the coupling device and the rear end of the vehicle		7670	mm	
11.	Length of the loading area		6000	mm	
12.	Rear overhang		2600	mm	
Masses					
13.	Mass of the vehicle in running order		570	kg	
13.1.	Distribution of this mass amongst the axles	On the coupling	100	kg	
		On axle 1	235	kg	
		On axle 2	235	kg	
13.2.	Actual mass of the vehicle		570	kg	
16.	Technically permissible maximum masses				
16.1.	Technically permissible maximum laden mass		3500	kg	
16.2.	Technically permissible mass on each axle	On axle 1	1800	kg	
		On axle 2	1800	kg	
		On axle 3	N/A	kg	
16.3.	Technically permissible mass on each axle group		Axle group 1	3000	kg
19.	Technically permissible maximum static mass on the coupling point		150	kg	
Maximum speed					
29.	Maximum speed		140	km/h	
Axles and suspension					
30.1.	Track of each steered axle		N/A	mm	
30.2.	Track of all other axles		2340	mm	
31.	Position of retractable axle(s)		N/A		
32.	Position of loadable axle(s)		N/A		
34.	Axle(s) fitted with air suspension or equivalent		No		
35.	Tyre/wheel combination	Tyre	195/50 R13		
		Rim	6 J x 13		
Brakes					
36.	Trailer brake connections		Mechanical		
Bodywork					
38.	Code for bodywork		DC		
Coupling device					
44.	Approval number or approval mark of coupling device		e1 00-0509		
45.1.	Characteristic values	D	30,95	kN	
		V	N/A	-	
		S	150	kg	
		U	N/A	t	
Miscellaneous					
50.	Type-approved according to the design requirements for transporting dangerous goods		No		
51.	For special purpose vehicles: designation in accordance with Annex II Section 5		N/A		
52.			N/A		

binnenkant

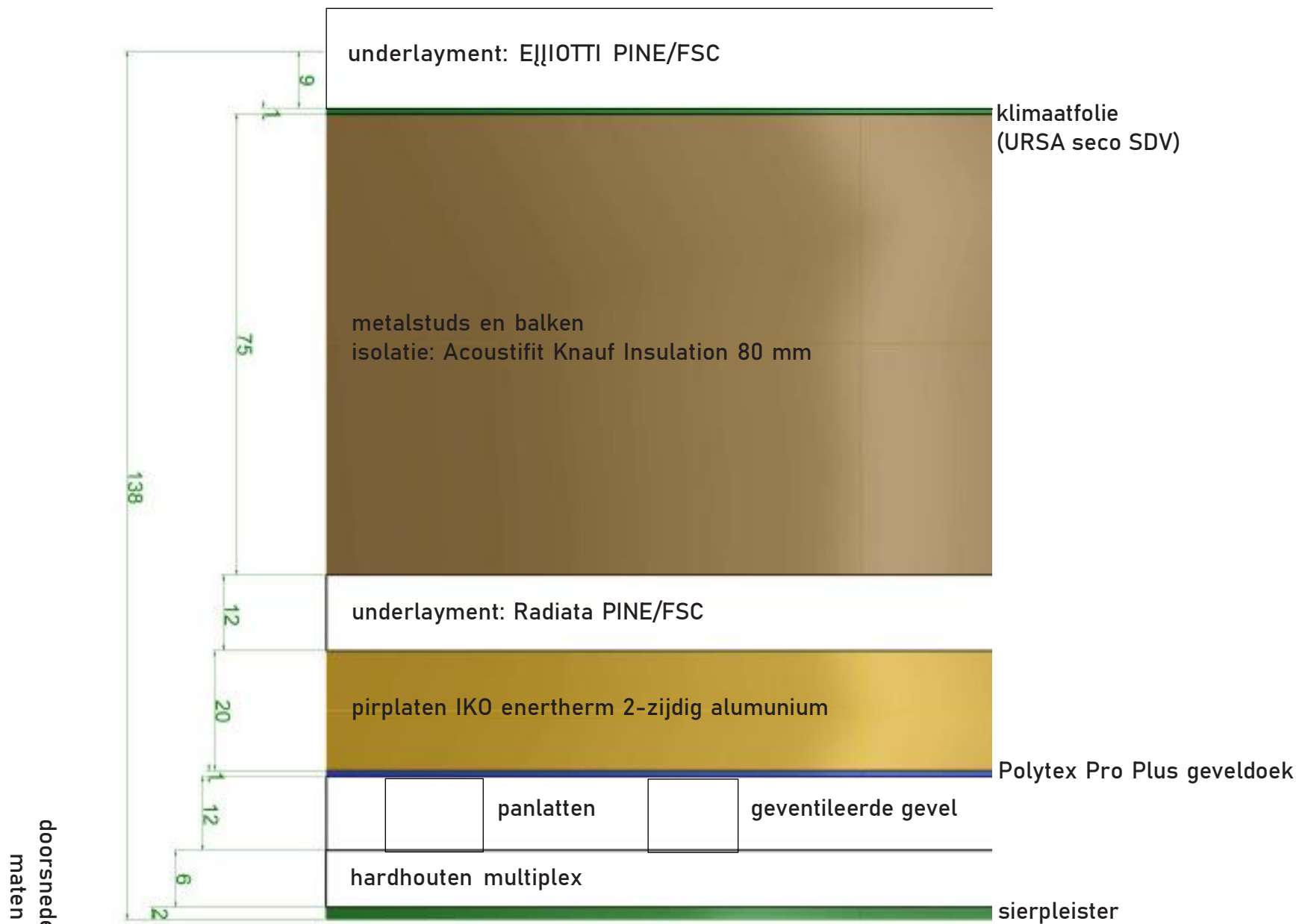

doorsnede wand
maten in mm

buitenkant

doorsnede vloer
maten in mm

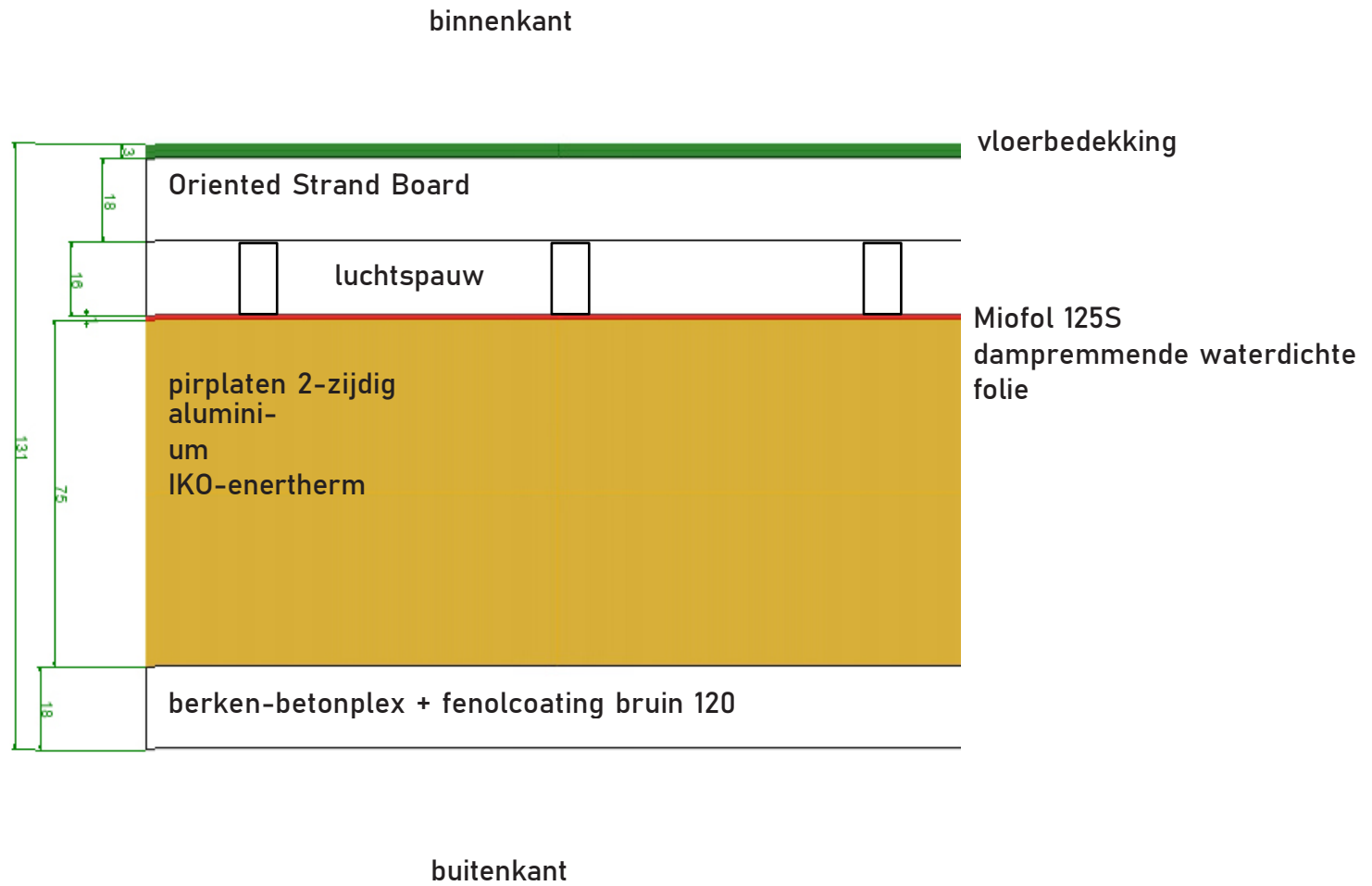

doorsnede dak
maten in mm

